

### Rodeo Transit Kit Installation

**List of items included in the transit kit:**

1. 4 Transit Anchors with hardware
2. 4 Transit Anchor Logo Stickers
3. 1 Transit Ready Serial Label Sticker

**Tools Required:**

1. 7/16" Wrench x2
2. 5/32" Allen wrench
3. 10 mm Wrench
4. #4 Allen Wrench
5. Hex Jaw Vice Grip (7-14mm opening)

- ! WARNING:** Follow installation instructions provided to securely install the transit anchors to your wheelchair.
- ! WARNING:** Only use high strength fasteners provided by Convaid to attach transit anchors.
- ! WARNING:** Transit anchors are to be installed one time only, using the hardware provided. Removal and reinstallation of transit anchors will weaken the fitting of the hardware.
- ! WARNING:** Engage wheel locks before installing transit anchors.
- ! WARNING:** For safety reasons, install the anchors one side at a time.
- ! WARNING:** For specific maximum transit weight capacity of your wheelchair, please see below:
  - RD10: 30 kg
  - RD12: 30 kg
  - RD14: 45.5 kg
  - RD16: 75.0 kg
- ! WARNING:** The use of Loctite® is required when installing these anchors. Not adding Loctite® could result in a failure of the anchor to perform as required in a vehicle accident.

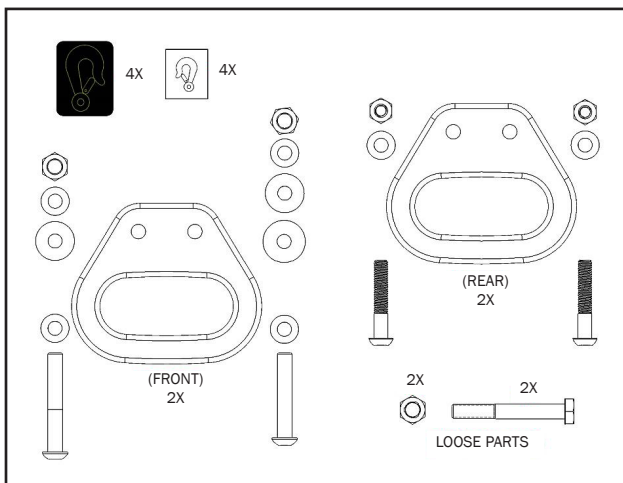

**NOTE:**

Order proper transit kit for your specific chair.

## To Install Front Anchors

**NOTE:** Jam nut can only be threaded from the front side. Fig. 1, Fig. 4

1. On the inside of the frame, remove nut and washer with 5/32" Allen wrench and 7/16" wrench. Fig. 2
2. Install the anchor with spacer washers to the inside of the frame. (Longer bolt in front) Fig. 3, Fig. 5
3. Push out the old bolts with the new hardware.
4. Install nuts and washers. (Thicker nut in front) Fig. 6
5. Tighten hardware with 5/32" Allen wrench and 7/16" wrench. (47 lb-in, 5.3 N-m)
6. Repeat for opposite side.

Fig. 1 Rear Anchors

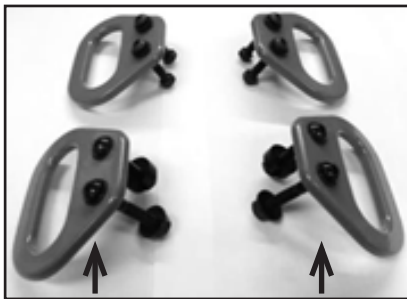

Left Front Right



Fig. 2



Fig. 3

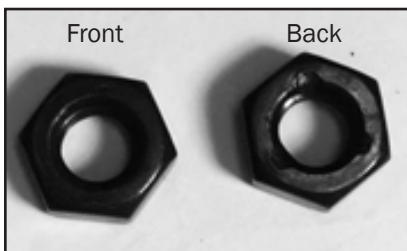

Fig. 4

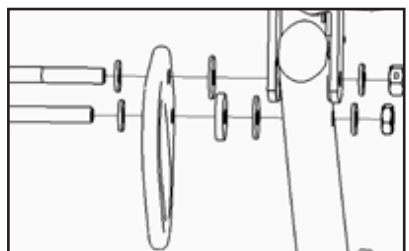

Fig. 5



Fig. 6

## To Install Front Anchors with Depth Adjustable Solid Seat Pan Option

1. Replace the long bolt in the front anchor assembly with the hex bolt. Fig. 7
2. On the inside of the frame, remove nut and washer with 5/32" Allen wrench and 7/16" wrench.
3. Install the anchor with spacer washers to the inside of the frame. (Longer bolt in front)
4. Push out the old bolts with the new hardware.
5. Install nuts and washers. (Thicker nut in front)
6. Tighten hardware with 5/32" Allen wrench and 7/16" wrenches. (47 lb-in, 5.3 N-m) Fig. 8
7. Repeat for opposite side.

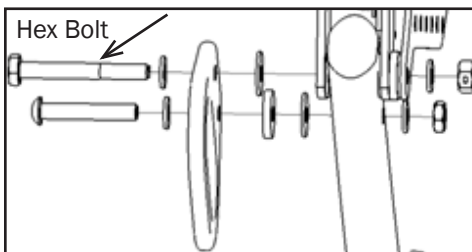

Fig. 7



Fig. 8

**To Install Rear Anchors**

1. Loosen transit pin with Hex jaw vice grip and 7/16" wrench. Fig. 9
2. Remove four washers on the outer side of the frame. Fig. 10
3. Remove hardware on the front bolt location. Fig. 11
4. Replace jam nut and install transit anchor as shown. Fig. 12
5. Apply Loctite® to the end of the rear bolt and tighten nut with #4 Allen wrench and 10 mm wrench (47 lb-in, 5.3 N-m). Fig. 13
6. Tighten transit pin with vice grip and 7/16" wrench.



Fig. 9

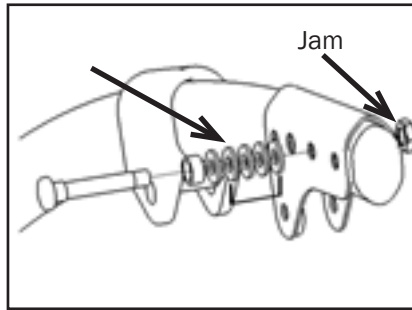

Fig. 10



Fig. 11

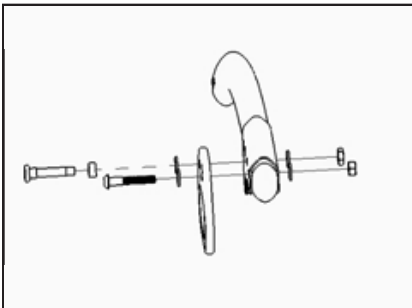

Fig. 12



Fig. 13



Fig. 14

**Anchor Logo Sticker**

Place anchor hook sticker next to all transit anchor locations. Fig. 14

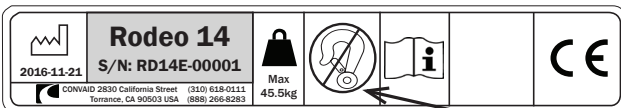

**Serial Label Sticker**

Place the transit ready sticker over the non-transit hook symbol on the serial label sticker. Fig. 15

